

## Technical Data

<b>Applicable Syringe Size</b>	2ml, 5ml, 10ml, 20ml, 30ml, 50/60ml	
<b>Rate</b>	2ml:0.01~60ml, 10ml:0.01~300ml, 30ml:0.01~900ml,	5ml:0.01~150ml 20ml:0.01~600ml 50/60ml:0.01~2200ml
<b>Bolus Rate &amp; Volume</b>	2ml:0.01~48ml/h 5ml:0.01~120ml/h 10ml:0.01~240ml/h 20ml:0.01~480ml/h 30ml:0.01~720ml/h 50/60ml:0.01~1500ml/h	0.1~0.5ml 0.1~1ml 0.1~5ml 0.1~10ml 0.1~10ml 0.1~10ml
<b>FF Rate</b>	2ml:0.01~60ml, 10ml:0.01~300ml, 30ml:0.01~900ml,	5ml:0.01~150ml 20ml:0.01~600ml 50/60ml:0.01~2200ml
<b>KVO Rate &amp; Volume</b>	Rate: 0.01 ~ 5.0ml/h Volume: 2ml:0~0.2ml, 10ml:0~0.2ml, 30ml:0~0.5ml,	
<b>Rate Accuracy</b>	Within $\pm 2\%$ (after calibration)	
<b>Occlusion Pressure Levels</b>	13 Levels are available	
<b>Alarms Information</b>	Injection finish, soon finish, VTBI finished, system stand-by freedom, injection is blocked, syringe falls off, syringe improperly installed, forgotten operation, low battery, battery runs out, abnormal running state, equipment failure, system power down etc.	
<b>Prompts</b>	Parameter overrun, injection begins, AC power has been pulled out, speed overrun.	
<b>Power Source</b>	Three options for power supply: First: 100~240VAC, 50/60Hz; Second: Inserted Li-battery 11.1V, capacity $\geq 2600$ mAh, 8 hours backup time at the rate of 5ml/h for a fully charged battery; Third: External DC 15V power supply.	
<b>Drug Library</b>	Up to 1000 drugs are provided	
<b>Dimensions</b>	300mm ( L ) $\times$ 180mm ( W ) $\times$ 90mm ( H )	



## Sunfusion<sup>®</sup> Syringe Pump Semi-1|Erch-3|Anim-5



Scan to know more



**BYOND 比扬医疗**  
Service call: 400-066-7111  
Add: Beyond Zone, Lijiacun Rd, Xueshi Street,  
Yuelu District, 410208 Changsha, China

**BYOND 比扬**

Pioneer in Life Science

# Sunfusion<sup>®</sup> Syringe Pump



Semi-1



Erch-3



Anim-5

## Innovative design Better sensibility

### > UI Design



- Brand-new appearance, small and lightweight, design as portable;
- 3.5" colorful touchscreen to display various information on one page;
- Easier operations are provided by simple UI design.

### > High-quality PBT Enclosure



- High-quality PBT enclosure, which makes medical disinfection and cleaning convenient;
- Multi - and Across - combination of syringe pump and infusion pump is enabled by Slide guide and lock catch design, which is safe and practical.

## Intelligent safety More care

### > Fast Start

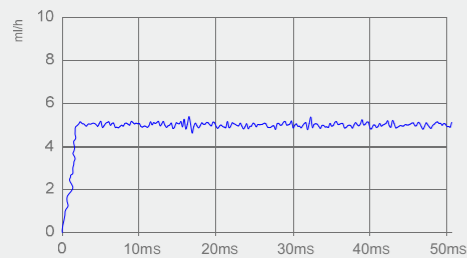

- 8 injection modes are able to satisfy various clinical needs;
- Applicable to 2ml, 5ml, 10ml, 20ml, 30ml, 50ml /60ml syringes;
- Rate are adjustable during running state.

### > Dynamic Alarm Instructions

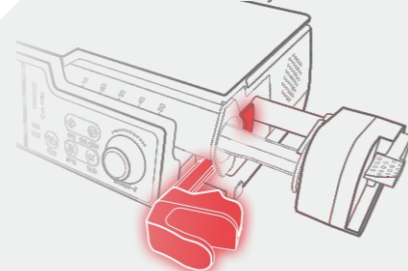

- 10 levels for forgotten operation time are selectable;
- 30 levels for near finished alarm time are optional to make supervision reliable;
- Intuitively demonstrate operation instructions by the application of Smart Alarm System.

### > Multi-function interface



- DC 15V Power connector;
- Multi-function connector;
- Compatible with either recommended syringes by default with great accuracy or other syringes by correct calibration.  $\leq \pm 2\%$  accuracy is achieved.

$\leq \pm 2\%$

**Precision**

0.01ml/h  
2200ml/h

**Rate**

IP24

**High IP Level**

13 Levels

**DPS**

## Features



### Auto-Lock Screen

Up to 11 levels time setting;  
Prevention for operation errors.



### Night Mode

Design for nighttime safe operation.



### Dual CPU

Guarantee for safe work.



### System Self-test

System self-test is conducted every time turning on, including alarm indicator, volume, pressure, air bubbles, etc;  
Safeguard for every-time use.



### Human Voice Alarm

Exclusive technology;  
Combination of human voice, readable words and visual light alarm;  
8 volume levels are available.



### WLAN Function

Capable of communicating with information management system;  
Remotely monitor patient's condition in real time.



### History Record Cassette

Up to 2000pcs records, including operation, alarm and modification;  
Trackable treatments are ensured.



### Certification

Certified by TÜV Rheinland and EN ISO13485 : 2016

